

LUXE Bidet® ELITE 110

Assembly Instruction

NAMES AND FUNCTIONS OF PARTS

Water feeding hose connection

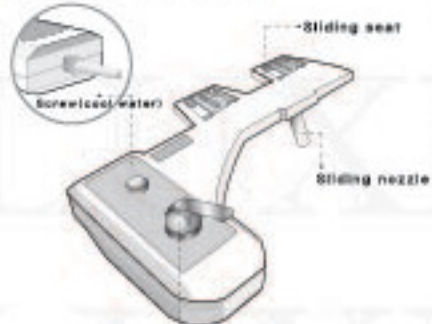

Parts



Installation Tools Needed



1

Remove the seat by unscrewing the seat.



2

Place the bidet on the toilet. Align the seat coupling holes. Screw the seat back onto the bidet and the toilet.

4

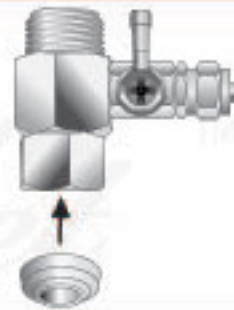

1. Make sure that there is a black rubber washer inserted inside of the T-adapter.
2. If it is not already there, insert it as shown.

5 Connecting Cool Water Supply

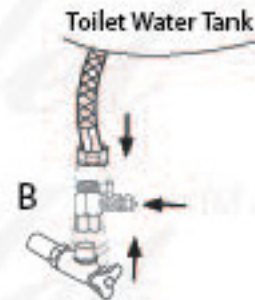

- A. Shut off the water supply.
- B. Disconnect the water connection from the tank.
- C. Connect the T-adapter to the water supply as shown in figure. Make sure that the compression nut is tightly screwed onto the T-adapter and white plastic tube.

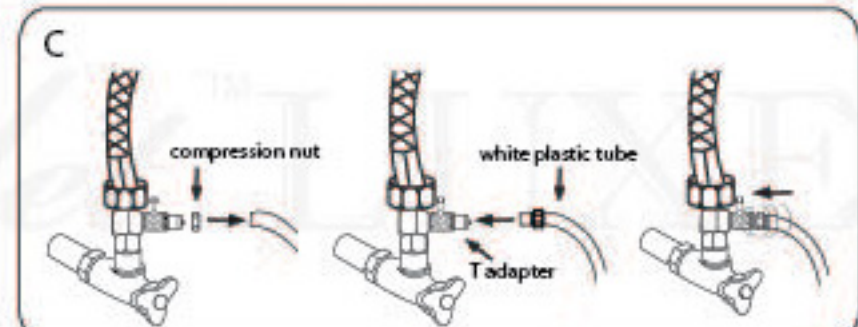

6

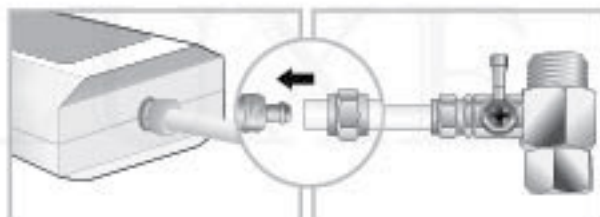

Cut off flexible tube according to bathroom dimensions.

7

1. Connect the T-adapter to the valve located at the back of the bidet panel.
2. Tighten the compression nuts to secure the connection.

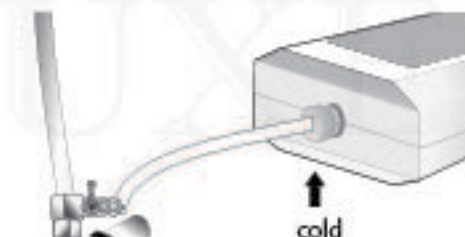
8

Connect the flexible tube to the cold water inlet on the bidet, tighten the compression nuts onto it.

LUXE *Bidet*[®] ELITE 110 Assembly Instruction

FINAL ASSEMBLED FIGURE

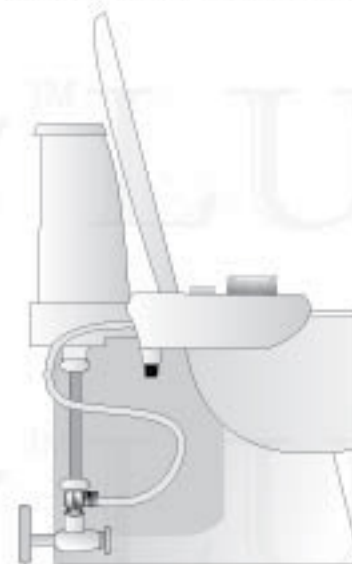

TRYING YOUR BIDET FOR THE FIRST TIME

Congratulations! You are ready to use the LuxeBidet for the first time. Be sure to pull up water pressure control knob gently until reaching your desired pressure. Water pressure control device is only to control water pressure, not for setting up the duration of water spray.

The working pressure of this product is 50 PSI ± 10 PSI

For more information, visit www.LuxeBidet.com.

©2Go Products, LLC